 HÄSSLEHOLM MILJÖ AB <small>VI BRINER FÖR EN HÅLLBAR FRAMTID</small>	Document name		
	Appendix B: Specific requirements for district heating		
Issued by	Approved by/manager	Date	Edition
The safety committee	Sven Carlsson	25 February 2019	01

Appendix B: Specific requirements for district heating

Personal protective equipment

- A helmet and safety shoes must be worn when in boiler rooms, fuel storage areas, and other production areas.
- Full protective clothing must be worn when work is to be carried out close to hot surfaces or hot media, or if there is a risk of being burnt. At least half of the protective clothing must be high visibility.
- For study visits, visitors must wear a helmet and a high-visibility vest printed with "Besökare" (Visitor). Safety shoes and full protective clothing are not required.

Specific areas

- When working in closed/confined electrically conductive spaces, only electrical equipment requiring a voltage of less than 50 V or equipment connected to an isolation transformer (SELV) may be used. Examples of confined electrically conductive spaces include boilers, tanks, and metal truss structures with dimensions that mean a person in that area is more or less in constant contact with the electrically conductive parts. The same rules apply to passage through manholes or other confined electrically conductive spaces that cannot be passed through without coming into contact with the electrically conductive environment.
- The air must be checked when working in confined spaces. Checks should be made for hydrogen sulphide (SH₂), oxygen (O₂), carbon monoxide (CO), and combustible gases (LEL). The meter is kept in the electrical workshop. Examples of enclosed/confined spaces include cisterns, boilers, flue gas channels, culverts, district heating chambers, and wells. The air should also be checked when in fuel containers, as well as when in tipping hoppers and fuel storage areas for biofuel and waste. It may be advisable to have a personal meter on you during your entire time in the aforementioned spaces.

General

- The maximum speed throughout the area is 20 km/h, unless otherwise stated. Beware of crossing vehicles!
- Defibrillators are available in signposted locations: Reception/entrance of Beleverket, old control room HR140 (waste boiler), and control room HR150 (biofuel boiler). Defibrillators are also located in HR440, in Tyringe, and at Drevet 4 at the entrance and on the wall outside the workshop.

> Part of the Municipality of Hässleholm

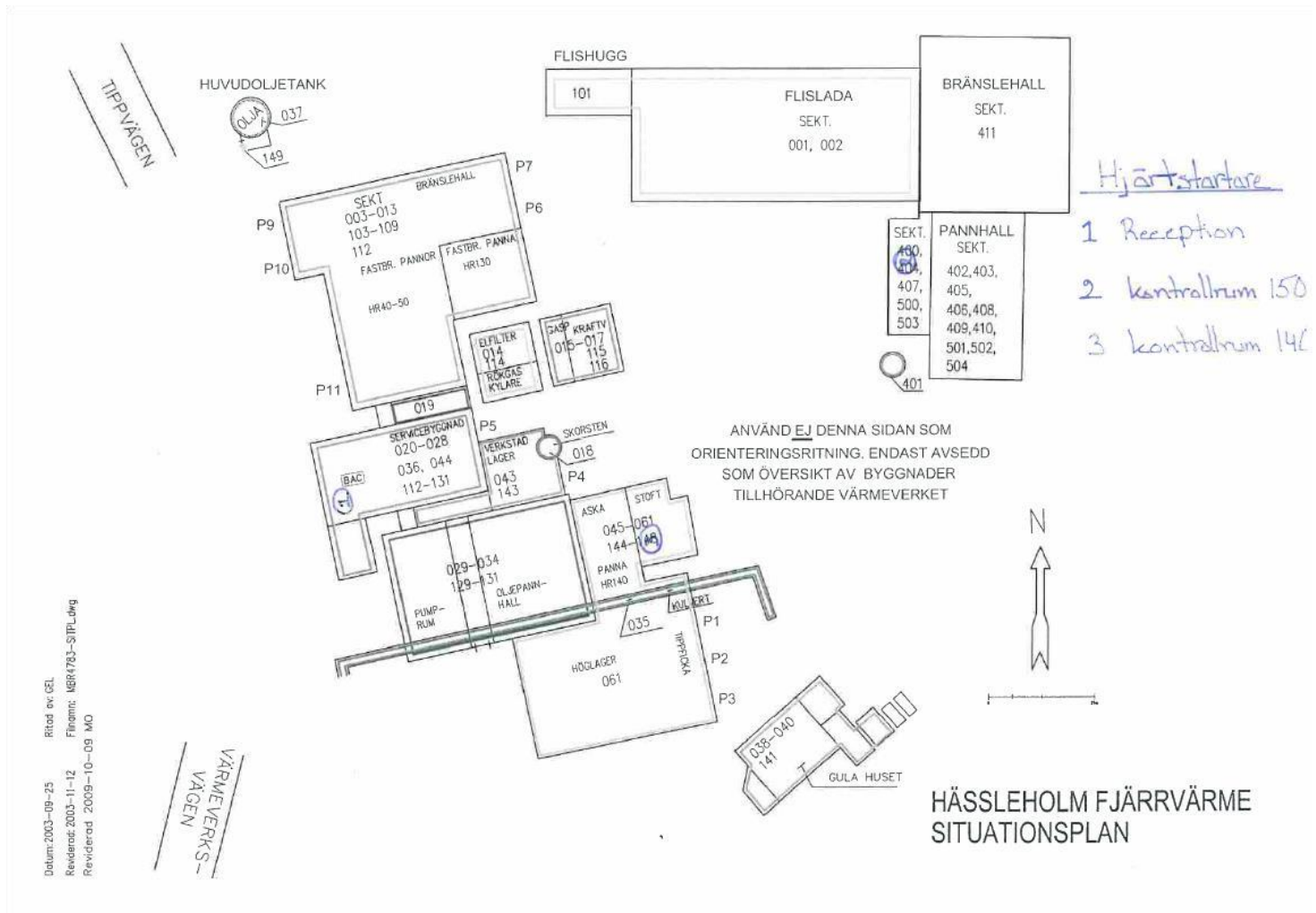

 HÄSSLEHOLM MILJÖ AB VI BRINER FÖR EN HÅLLBAR FRAMTID	Document name Appendix B: Specific requirements for district heating		
	Issued by The safety committee	Approved by/manager Sven Carlsson	Date 25 February 2019

I have read and understood the above:

Name (written) and company:

Date and signature:

The signed part of the document is retained by HMAB.

> Part of the Municipality of Hässleholm